

FOR	ELECTRODE TYPE LEVEL SENSOR		
MOUNTING	TOP FLANGE		
ENCLOSURE	WEATHER PROOF (IP65)		
MAX. PRESSURE	10	kgf/cm	
MAX. TEMP	350	°C	
CABLE ENTRY	PF 3/4(F)		
	<input type="checkbox"/>		

NO.	DESCRIPTION	MATERIAL	REMARK
1	HOUSING	AL.C	
2	PROCESS CONN.	304 SS	
3	INSULATION	CERAMIC	
4	ELECTRODE	316L SS	φ6
5	GROUND ELECTRODE	316L SS	
6	COOLING FIN	304 SS	

PROCESS CONN. SIZE						
<input type="checkbox"/> 100A JIS 10K RF						
<input type="checkbox"/>						

TAG. NO.	Q'TY	L1	L2	L3	L4	L

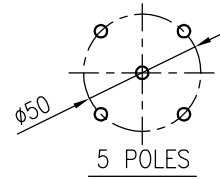

NOTE
1. GENERAL TOLERANCE : ±5mm EXCEPT AS NOTED.

△	.	.				
△	.	.				
△	.	.				
△	.	.				
△	Apr. 2018	1ST ISSUE	D Y KIM	B S SUNG	Y H KIM	
NO.	DATE	REVISION	REV'D BY	CHK'D BY	APP'D BY	

HITROL HITROL CO., LTD.
TITLE
**ELECTRODE TYPE LEVEL SENSOR
HE-5H-S**

SCALE	UNIT	SHEET NO.
N.S	mm	
PROJECT		
DRAWING NO.		
HE5HS-A-01		

This drawing is the property of HITROL and shall not be copied, communicated, or given for third-party permission without our written permission.