

FOR	ELECTRODE TYPE LEVEL SENSOR
MOUNTING	TOP FLANGE
ENCLOSURE	WEATHER PROOF (IP65)
MAX. PRESSURE	10 kgf/cm ²
MAX. TEMP	150 °C

CABLE ENTRY	PF 3/4"(F)
	<input type="checkbox"/>

NO.	DESCRIPTION	MATERIAL	REMARK
1	HOUSING	AL.C	
2	PROCESS CONN.	304 SS	
3	ELECTRODE	316L SS	φ6
4	INSULATION	TEFLON	
5	GROUND ELECTRODE	316L SS	φ5

PROCESS CONN. SIZE	
<input type="checkbox"/>	PT 2"(M)
<input type="checkbox"/>	

TAG. NO.	Q'TY	L1	L2	L3	L

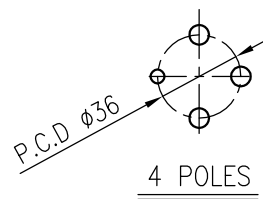

NOTE
1. GENERAL TOLERANCE : ±5mm EXCEPT AS NOTED.

						HITROL CO., LTD.	SCALE	UNIT	SHEET NO.
							N.S	mm	
						TITLE ELECTRODE TYPE LEVEL SENSOR HE-4H	PROJECT		
							DRAWING NO. HE4H-A-01		
	Apr. 2018	1ST ISSUE	D Y KIM	B S SUNG	Y H KIM				
NO.	DATE	REVISION	REV'D BY	CHK'D BY	APP'D BY				

This drawing is the property of HITROL and shall not be copied, communicated, or given for third-party except with our written permission