

FOR	ELECTRODE TYPE LEVEL SENSOR
MOUNTING	TOP FLANGE
ENCLOSURE	WEATHER PROOF (IP65)
MAX. PRESSURE	10 kgf/cm ²
MAX. TEMP	150 °C

CABLE ENTRY	PF 3/4"(F)
	<input type="checkbox"/>

NO.	DESCRIPTION	MATERIAL	REMARK
1	HOUSING	AL.C	
2	PROCESS CONN.	304 SS	
3	ELECTRODE	316L SS	∅6
4	INSULATION	TEFLON	
5	GROUND ELECTRODE	316L SS	∅5

PROCESS CONN. SIZE	
<input type="checkbox"/>	PT 2"(M)

TAG. NO.	Q'TY	L1	L2	L

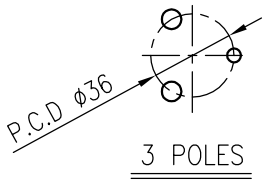

NOTE
1. GENERAL TOLERANCE : ±5mm EXCEPT AS NOTED.

△					
△					
△					
△					
△	Apr. 2018	1ST ISSUE	D Y KIM	B S SUNG	Y H KIM
NO.	DATE	REVISION	REV'D BY	CHK'D BY	APP'D BY

HITROL HITROL CO., LTD.
TITLE
ELECTRODE TYPE LEVEL SENSOR
HE-3H

SCALE	UNIT	SHEET NO.
N.S	mm	
PROJECT		
DRAWING NO.		
HE3H-A-01		

This drawing is the property of HITROL and shall not be copied, communicated, or given for third-party permission without our written permission.