

PO		TN	
----	--	----	--

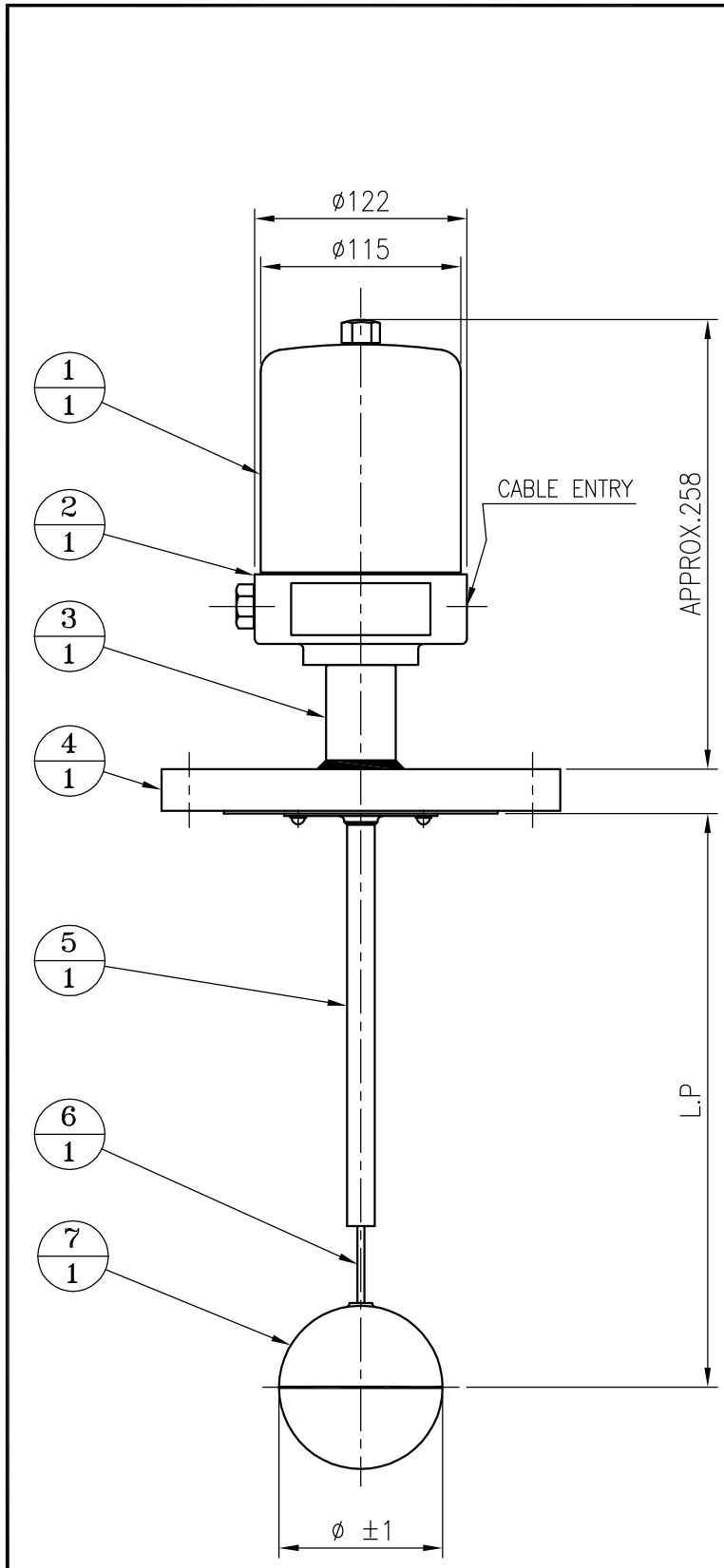

FOR	LEVEL SWITCH
MOUNTING	TOP
ENCLOSURE	WEATHER PROOF (IP65)
AMBIENT TEMP	-20~+80°C
MAX. PRESSURE	kgf/cm ²
MAX. TEMP	120 °C

CABLE ENTRY	PF 3/4"(F)
<input type="checkbox"/>	

NO.	DESCRIPTION	MATERIAL	REMARK
1	COVER	C.S	
2	BASE	AL.C	
3	CONNECTOR	316L SS	
4	PROCESS CONN.	<input type="checkbox"/> 304 SS <input type="checkbox"/> 316L SS	
5	ROD GUIDE	316L SS	
6	ROD	316L SS	
7	FLOAT	316L SS	

PROCESS CONN. SIZE	FLOAT SIZE
<input type="checkbox"/> 100A JIS 10K RF	φ94
<input type="checkbox"/> 125A JIS 10K RF	φ114
<input type="checkbox"/>	

ELECTRICAL SPECIFICATION		
SWITCH	TYPE	MICRO
	FORM	<input type="checkbox"/> 1-SPDT <input type="checkbox"/> 1-DPDT
	CONTACT RATING	AC 250V, 15A DC 125V, 0.5A

SWITCH ACTION	
SWITCH NO.1	<input type="checkbox"/> HIGH LEVEL (N.O) <input type="checkbox"/> LOW LEVEL (N.C)

TAG NO.	Q'ty	L.P

NOTE
1. GENERAL TOLERANCE ±3mm EXCEPT AS NOTED.

HITROL CO., LTD.						SCALE	UNIT	SHEET NO.
						N.S	mm	/
TITLE FLOAT TYPE LEVEL SWITCH HM-95						PROJECT		
						DRAWING NO. HM95-A-01		
NO.	DATE	REVISION	REV'D BY	CHK'D BY	APP'D BY			
	JAN. 2018	1st ISSUE	D Y KIM	B S SUNG	Y H KIM			

This drawing is the property of HITROL and shall not be copied, communicated, or given for third-party permission